

**STEVENS  
MEETING  
CENTER**

	Square Feet	Square Meters	Dimensions L x W	Ceiling Height Max*	Ceiling Height Max Meters	Ceiling Height Min.	Ceiling Height Min. Meters	Column Size	Floor Load	Floor Surface	8' x 10' Booths	10'x10' Booths	Banquet 10/60"
Salon A	40,140	3729.13	195'x200'	11' 4"	3.18	10'	0.93	4'4"x3'4"	100 lbs/sq. ft.	Carpet	144	139	2,000
Salon B	9,204	855.08	176'x96'	9.5' 5"	2.87	8.5' 5"	0.79	3' x 2'6"	100 lbs/sq. ft.	Carpet	26	26	180
Salon C	28,906	1986.64	200'x149'	10'2"	3.10	10'2"	0.95	4'6"x4'6"-5'	100 lbs/sq. ft.	Carpet	88	98	1,000
Salon C, Office A	112	10.41	14'x8'	10'2"	3.10	10'2"	0.95	-	-	Carpet	-	-	-
Salon C, Office B	330	30.66	33'x10'	10'2"	3.10	10'2"	0.95	-	-	Carpet	-	-	-
Salon D	34,884	3240.83	205'x170'	10'	3.05	8'9"	0.83	2'2"x2'2"x2'8"	100 lbs/sq. ft.	Carpet	113	108	1,100





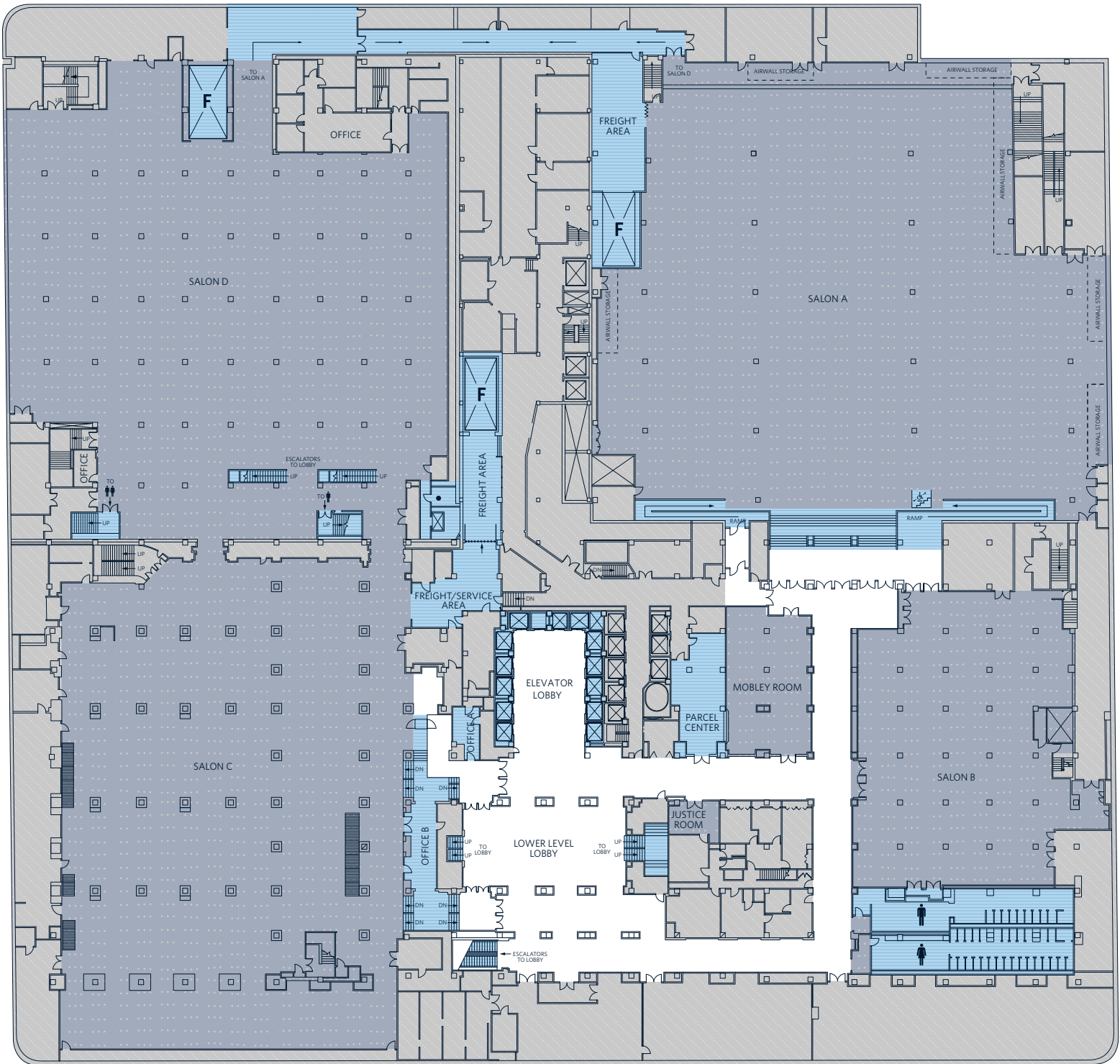

\*All capacities are based on usable square footage

	Square Feet	Square Meters	Dimensions L x W"	Ceiling Height	Ceiling Height Meters	Theater	School Room 2/6'	School Room 3/6'	Banquet 10/60"	Reception	Conference
Mobley Room	1,972	183.20	34'x58'	8'6"	2.59	65	24	36	80	150	28
Justice Room	320	29.73	16'x20'	7'11.5"	2.41	-	-	-	-	-	-

\*All capacities are based on usable square footage



### KEY

- |                                                                                                              |                                                                                                        |
|--------------------------------------------------------------------------------------------------------------|--------------------------------------------------------------------------------------------------------|
|  Meeting/Conference Rooms |  ADA Elevator     |
|  Amenities                |  ADA Lift         |
|  Heart of House           |  Restrooms        |
|                                                                                                              |  Elevator         |
|                                                                                                              |  Freight Elevator |

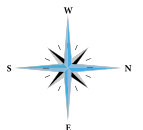







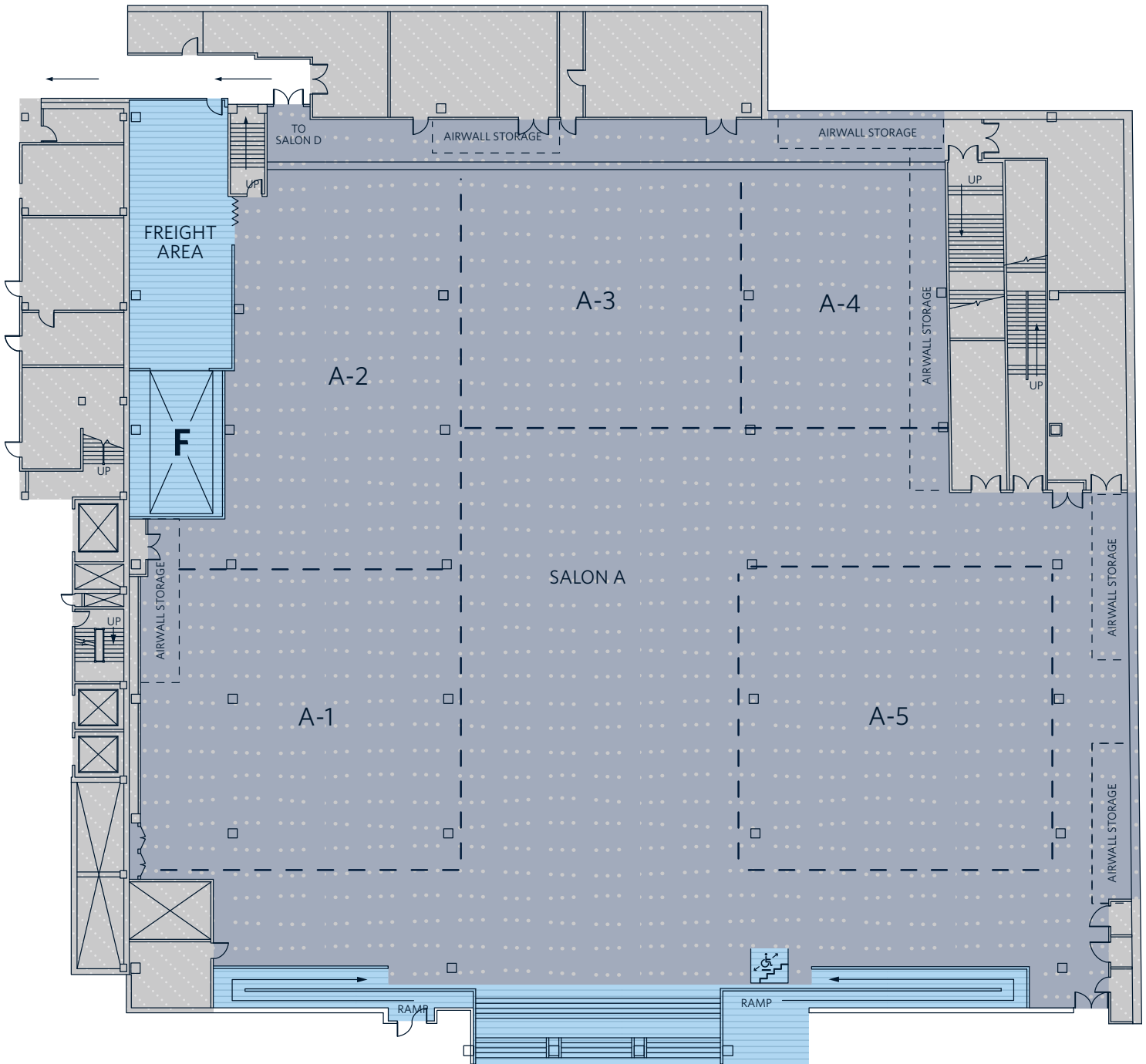

<b>SALON A</b>	Square Feet	Square Meters	Dimensions L x W	Ceiling Height Max*	Ceiling Height Max Meters	Ceiling Height Min.	Ceiling Height Min. Meters	Theater	School Room 2/6'	School Room 3/6'	Banquet 10/60"	Reception	Conference	8'x10' Booths	10'x10' Booths
Salon A	40,140	3729.13	195'x200'	11'4"	3.18	10'2"	3.10	2,950	570	855	2,000	3,000	n/a	144	139
Salon A, Pre-function	5,060	470.09	92'x55'	11'4"	3.18	10'2"	3.10	500	180	270	600	1,200	n/a	-	-
Salon A-1	3,844	357.12	55'x62'	11'4"	3.18	10'2"	3.10	120	120	180	300	360	40	-	-
Salon A-2	3,772	350.43	82'x46'	11'4"	3.18	10'2"	3.10	120	120	180	300	360	40	-	-
Salon A-3	2,916	270.91	54'x54'	11'4"	3.18	10'2"	3.10	106	106	159	250	340	40	-	-
Salon A-4	2,214	205.69	54'x41'	11'4"	3.18	10'2"	3.10	80	80	120	120	300	30	-	-
Salon A-5	3,965	368.36	65'x61'	11'4"	3.18	10'2"	3.10	132	132	198	320	425	40	-	-

\*All capacities are based on usable square footage

\*\*Ceiling height under airwalls is 10'2"



## KEY

- |                                                                                                              |                                                                                                        |
|--------------------------------------------------------------------------------------------------------------|--------------------------------------------------------------------------------------------------------|
|  Meeting/Conference Rooms |  ADA Elevator     |
|  Amenities                |  ADA Lift         |
|  Heart of House           |  Restrooms        |
|                                                                                                              |  Elevator         |
|                                                                                                              |  Freight Elevator |

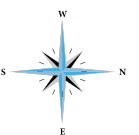

<b>SALON C</b>	Square Feet	Square Meters	Dimensions L x W	Ceiling Height	Ceiling Height Meters	Theater	School Room 2/6'	School Room 3/6'	Banquet 10/60"	Reception	Conference 2/6'	Conference 3/6'	Hollow Sq. 3/6'	U-Shape 3/6'
Salon C	28,906	1986.64	-	10'2"	3.10	-	-	-	1,000	-	-	-	-	-
Salon C, Pre-function	6,208	576.74	-	10'2"	3.10	-	-	-	500	600	-	-	-	-
Salon C, Office A	112	10.41	14'x8'	10'2"	3.10	-	-	-	-	-	-	-	-	-
Salon C, Office B	330	30.66	33'x10'	10'2"	3.10	-	-	-	-	-	-	-	-	-
Salon C-1	1,131	105.07	39'x29'	10'2"	3.10	83	30	45	60	75	24	34	48	39
Salon C-2	1,131	105.07	39'x29'	10'2"	3.10	66	24	36	80	60	20	28	42	33
Salon C-3	1,443	106.19	39'x37'	10'2"	3.10	120	40	60	90	100	24	34	54	42
Salon C-4	1,443	106.19	39'x37'	10'2"	3.10	105	32	48	90	90	20	28	48	36
Salon C-5	1,326	123.19	39'x37'	10'2"	3.10	120	38	57	90	100	24	34	48	39
Salon C-6	1,326	123.19	39'x34'	10'2"	3.10	105	30	45	90	90	20	28	42	33
Salon C-7	858	79.71	39'x22'	10'2"	3.10	70	30	45	70	60	24	34	42	36
Salon C-8	858	79.71	39'x22'	10'2"	3.10	66	30	45	60	60	20	28	36	30
Salon C-1,2	2,262	210.15	78'x29'	10'2"	3.10	171	60	90	180	150	44	64	78	69
Salon C-3,4	2,886	268.12	78'x37'	10'2"	3.10	255	80	120	220	240	44	64	84	72
Salon C-5,6	2,652	246.38	78'x34'	10'2"	3.10	255	74	111	220	240	44	64	78	69
Salon C-7,8	1,716	159.42	78'x22'	10'2"	3.10	150	62	108	150	125	44	64	72	66
Salon C-1,2,3,4	5,148	478.26	78'x66'	10'2"	3.10	426	140	210	400	400	-	-	-	-
Salon C-5,6,7,8	4,368	405.80	78'x56'	10'2"	3.10	405	146	219	370	385	-	-	-	-
Salon C-1,2,3,4,5,6,7,8	9,516	884.07	78'x122'	10'2"	3.10	-	-	-	770	700	-	-	-	-

All capacities are based on usable square footage  
 Airwalls in Salon C cannot be reconfigured while meetings are in session

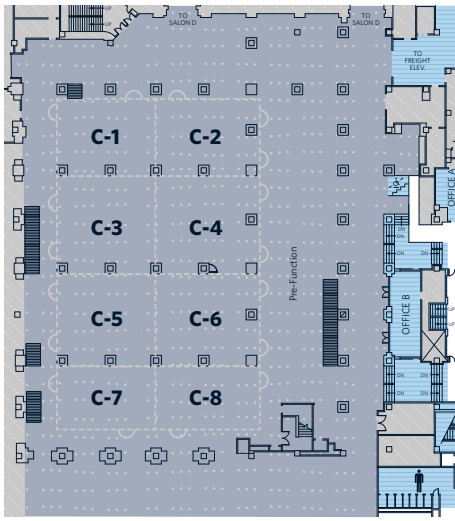

Salon C, Layout Option 1

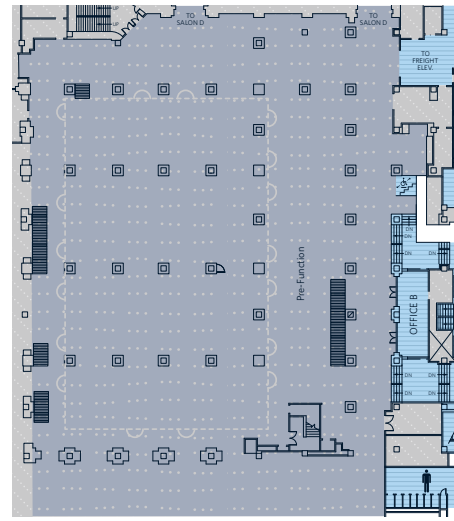

Salon C, Layout Option 4

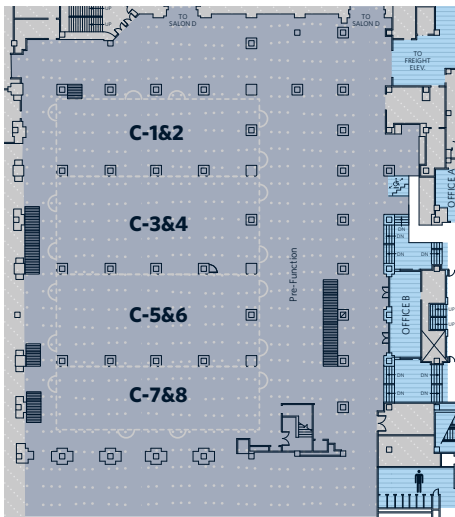

Salon C, Layout Option 2

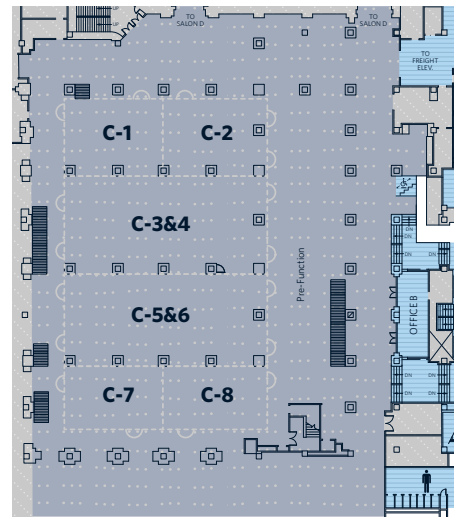

Salon C, Layout Option 5

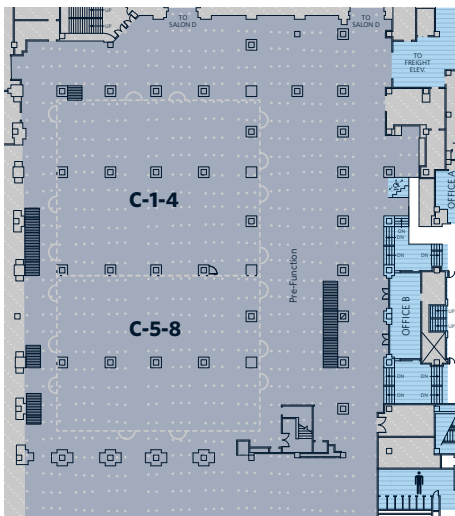

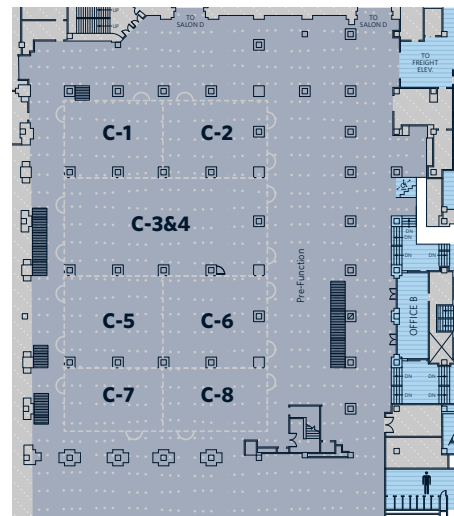

Salon C, Layout Option 3



Salon C, Layout Option 6

## KEY

-  Meeting/Conference Rooms
-  Amenities
-  Heart of House

